

ESCOLA MUNICIPAL ROSALINA DE MORAES
LIMITES DO TERRENO

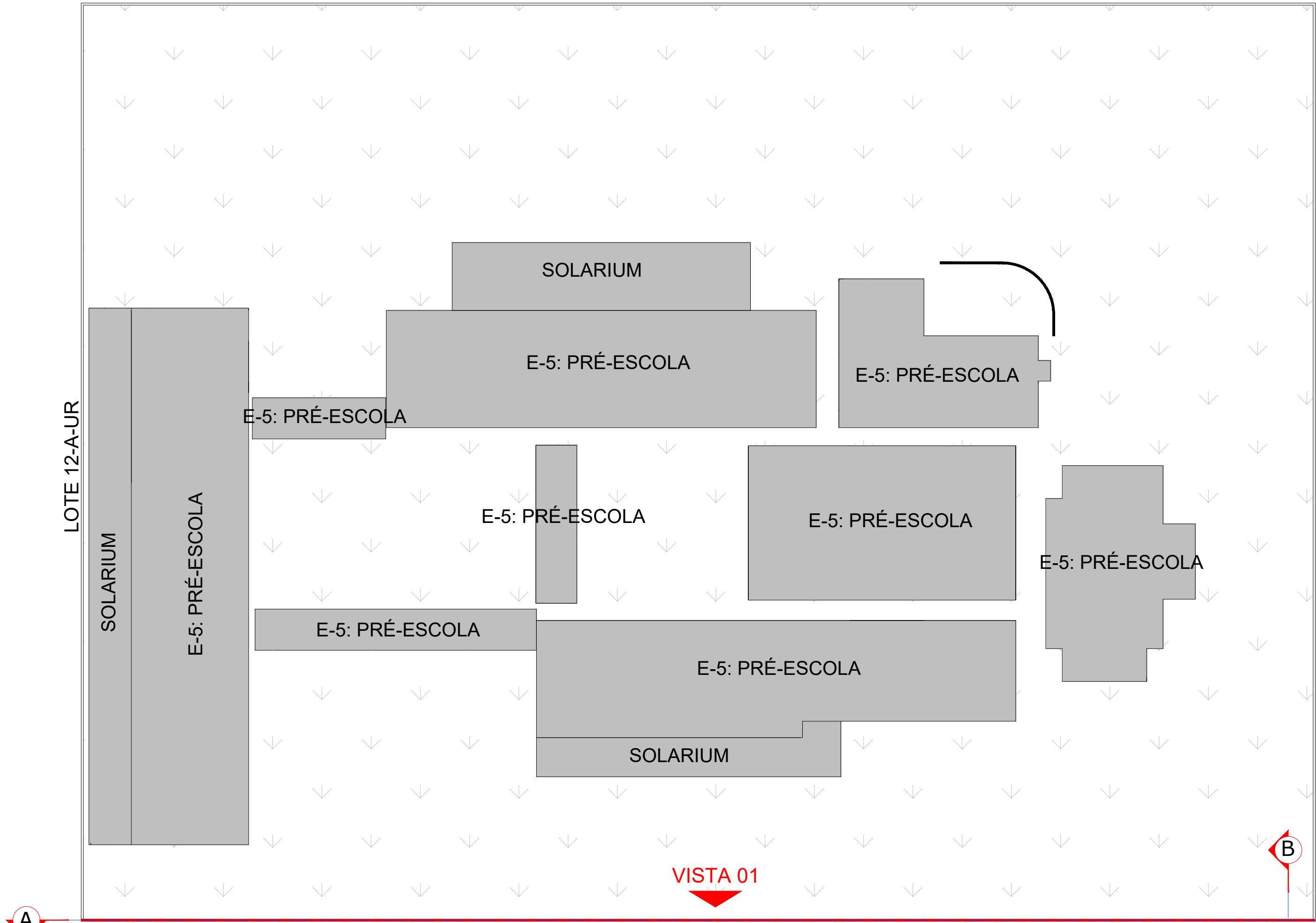

IMPLANTAÇÃO/REPRESENTAÇÃO
ESCALA 1:250

MURO RESTANTE A SER DEMOLIDO E CONSTRUÍDO NOVO NO LOCAL

LIMITES DO TERRENO
LOTES: 1, 2, 3, 4, 5, 6



IMAGEM ILUSTRATIVA—MÃO FRANCESA E MURO DE ARRIMO



IMAGEM ILUSTRATIVA—MURO EM PLACA CIMENTICIA

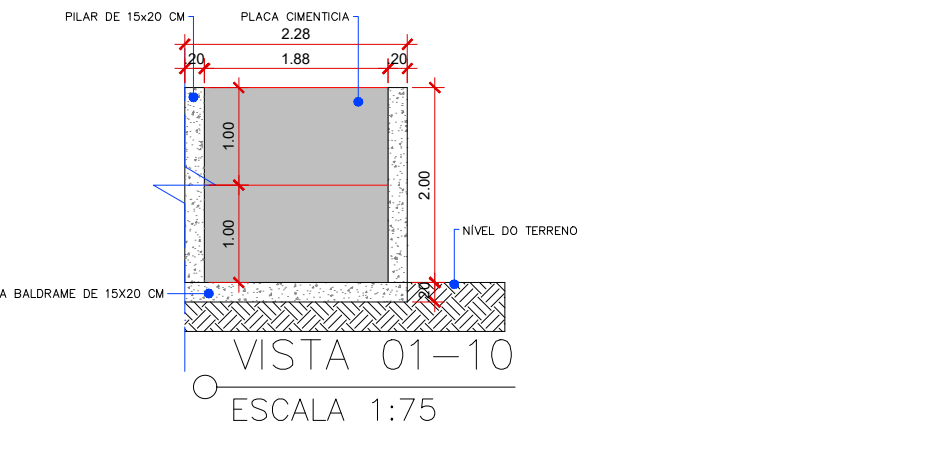
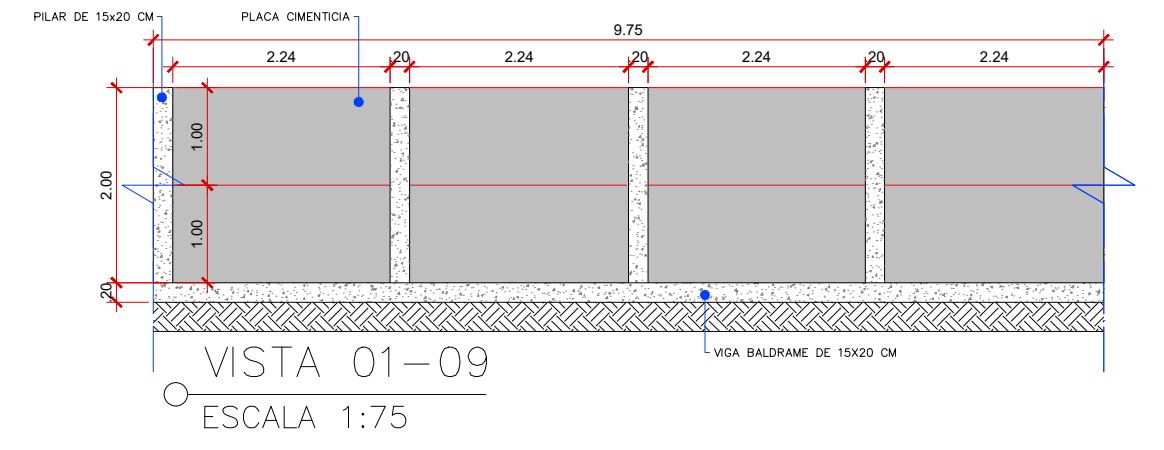
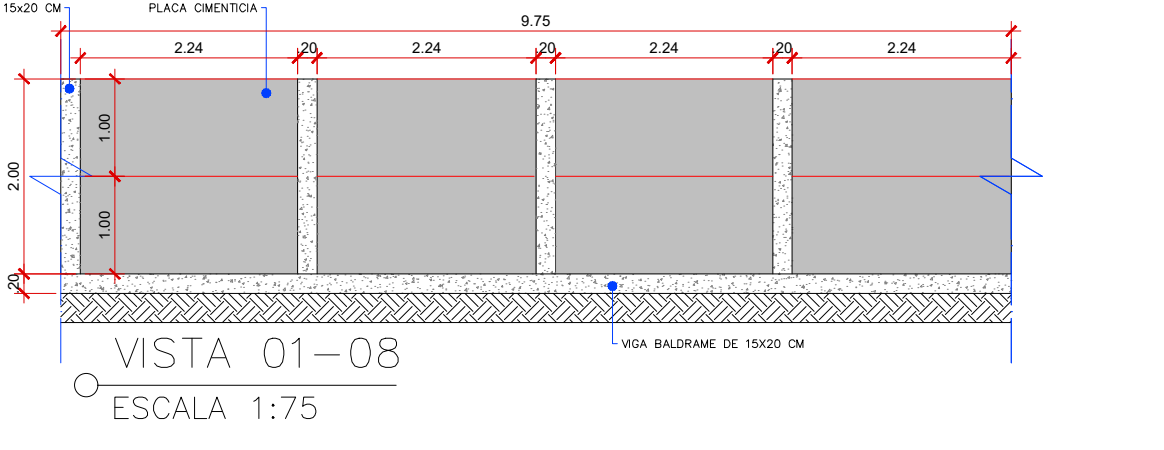
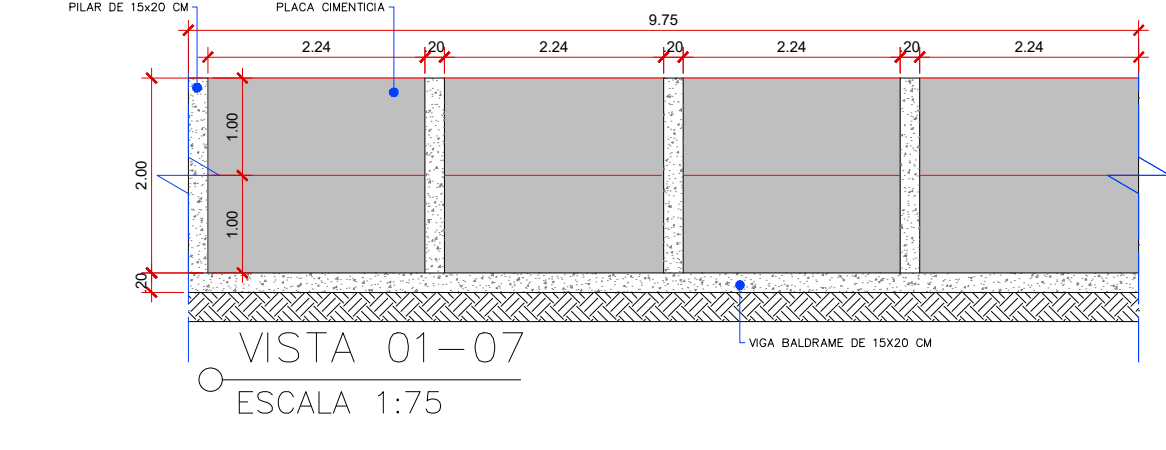
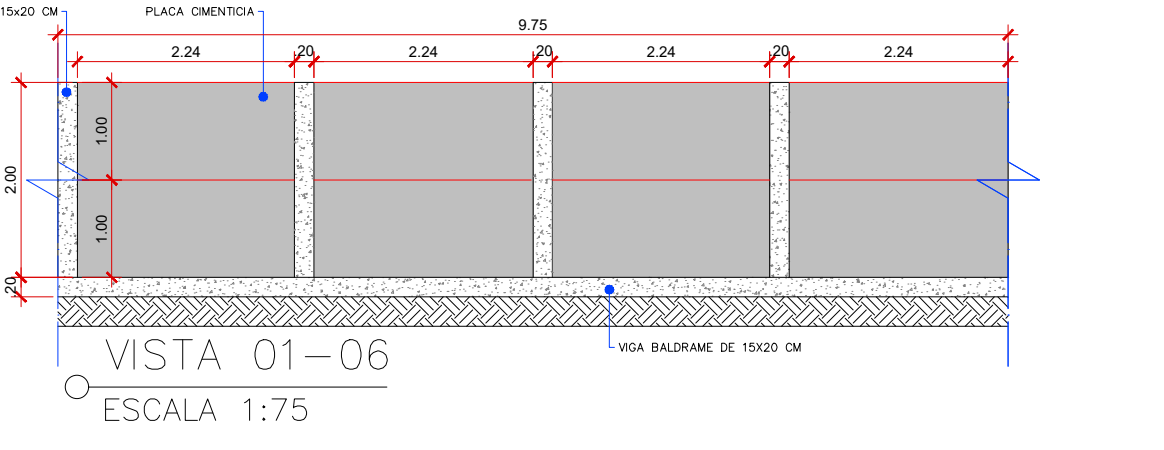
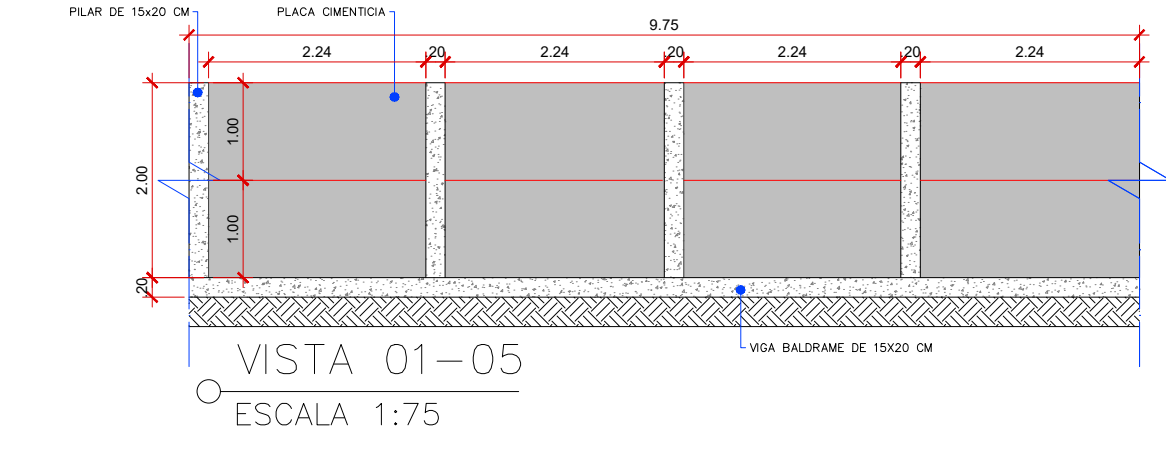
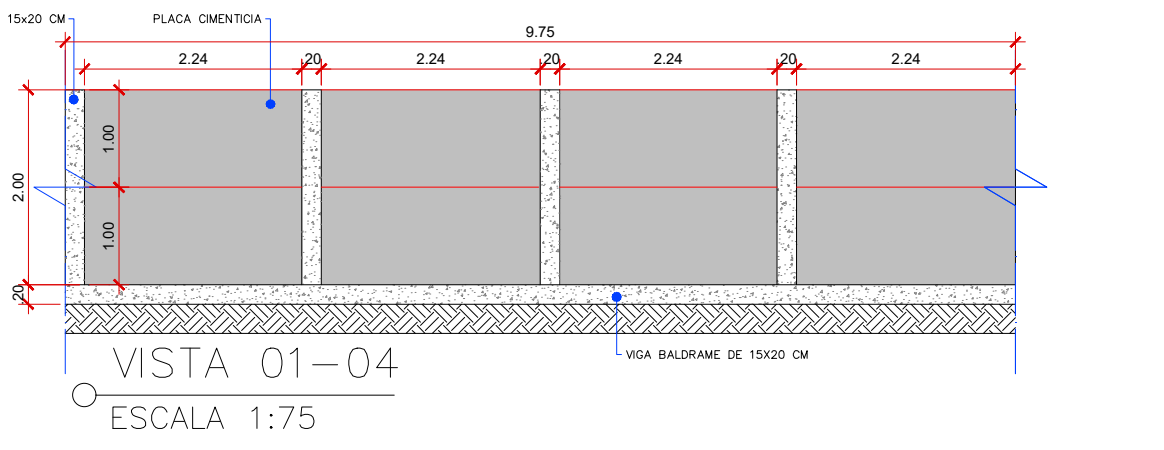
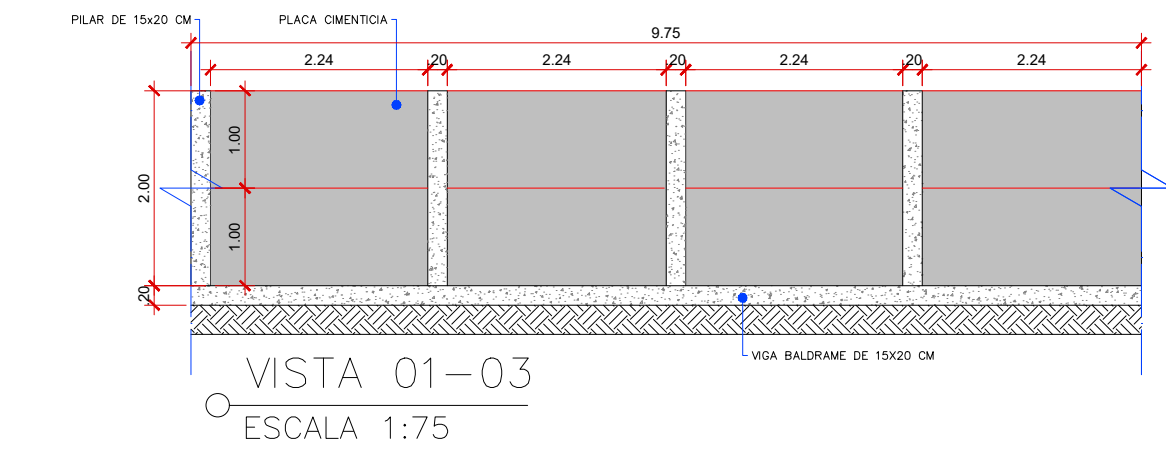
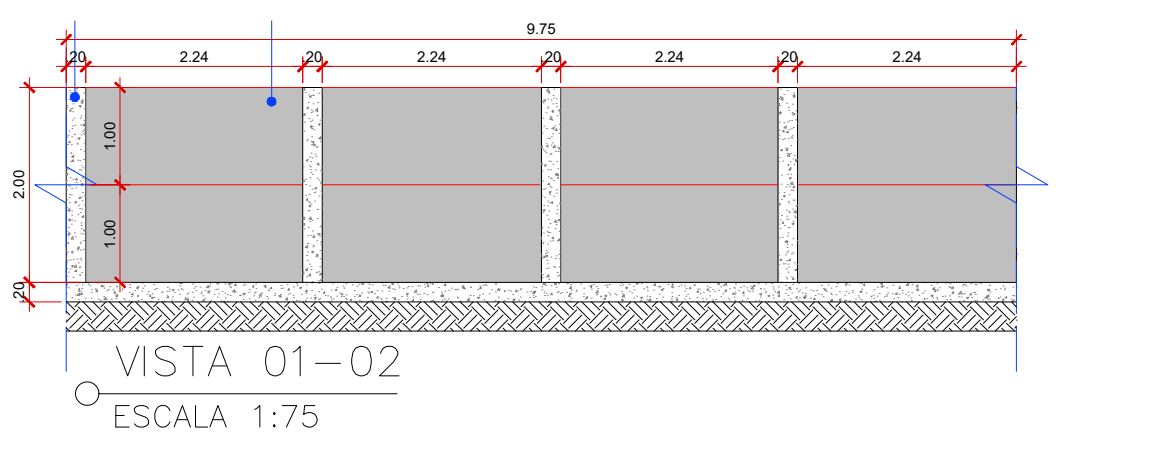
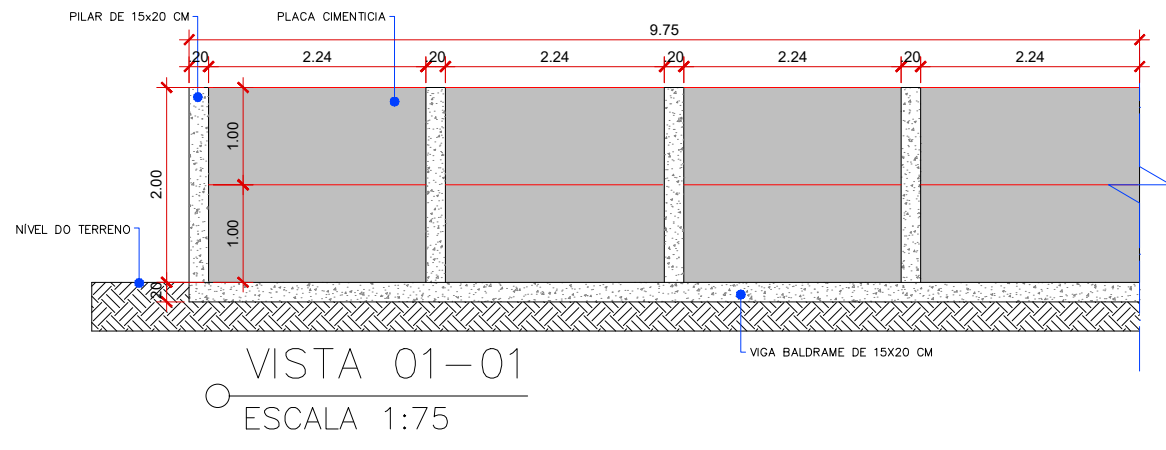
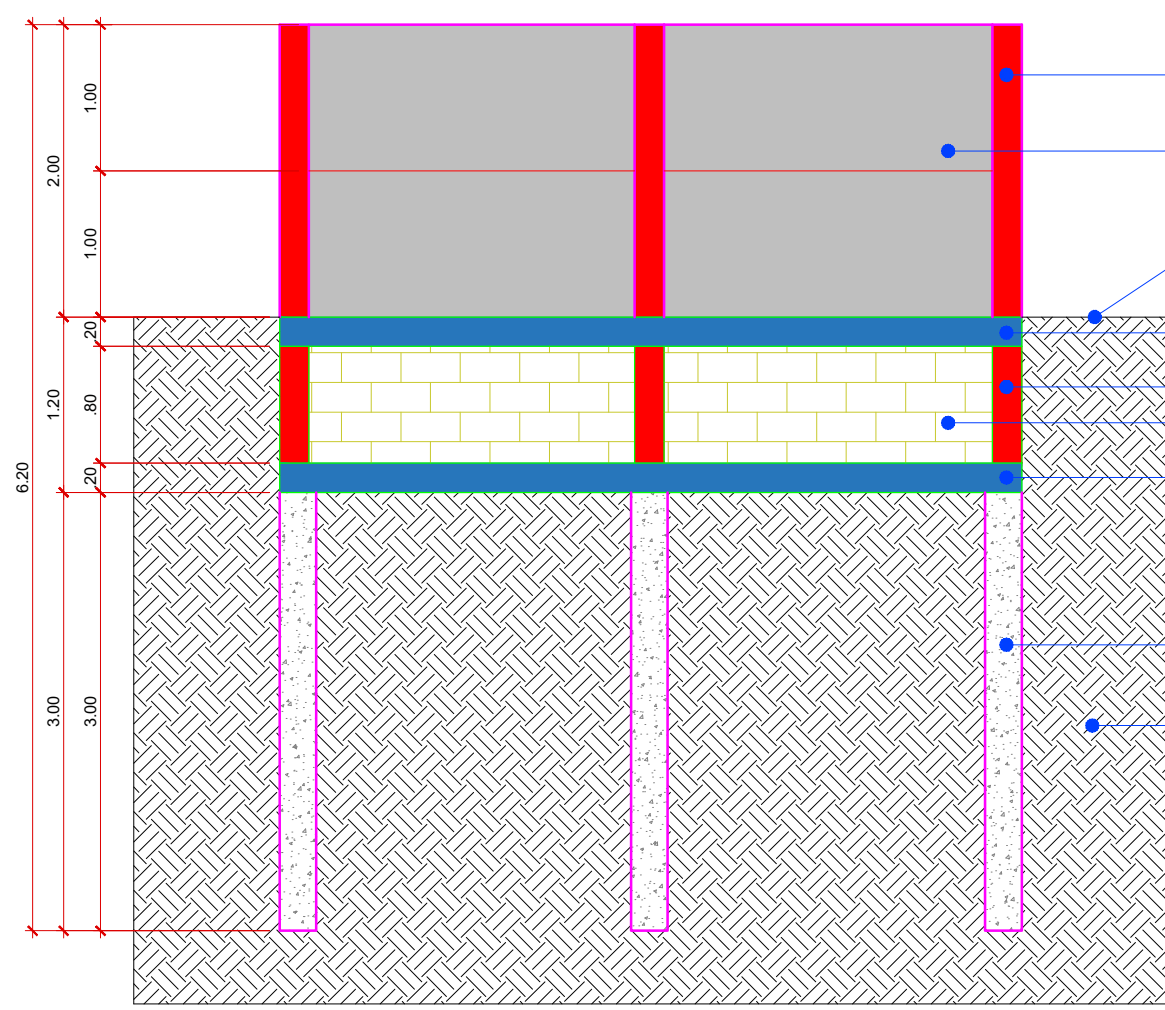

CORTE "AA"
ESCALA 1:50

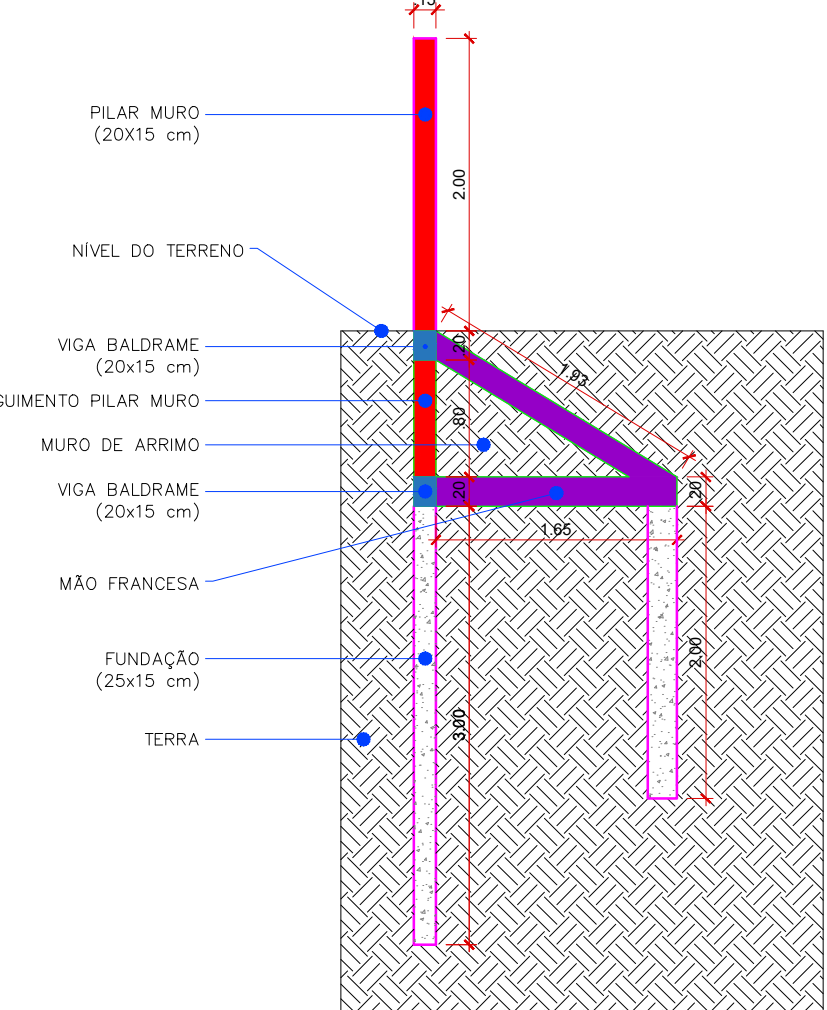

CORTE "BB"
ESCALA 1:50

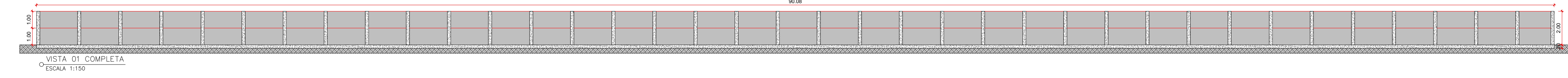

MUNICÍPIO DE TERRA RICA - PARANÁ
SECRETARIA MUNICIPAL DE ADMINISTRAÇÃO
DIVISÃO DE ENGENHARIA E PLANEJAMENTO
Avenida Euclides da Cunha, 1120 - 87890-000 Terra Rica - PR
projeto@terrarica.pr.gov.br - 44 3441-8541

Planta de Reforma

REFORMA MURO DA CRECHE JOÃO MARCOS

Proprietário	PREFEITURA MUNICIPAL DE TERRA RICA		CPF / CNPJ	76978881/0001-81
Cadastro	Quadra	12-A-UR	Lot	
Endereço				
Bairro/Gleba/Loteamento:		VILA BARBOSA		
CEP		87890-000		
Observações:				
Áreas:		TERRENO 6.030,00 m2		
ÁREA REFORMADA		270,00 m2		
TOTAL		270,00 m2		
Situação Esquemática:				
Autenticação da Prefeitura Municipal de Terra Rica (PR)				
Observações:				